

(RAJESH DUTT) JDI(HQ) (SUREKHA YADAV) ATP(HQ) (SUNENA) DTP (HQ) (SANJAY KUMAR) STP (E&V) (RAMESH SINGH) TPI(HR) (T.L. SATYAPRAKASH, IAS) DTCPC (HR)

This is a "PROVISIONAL APPROVED LAYOUT PLAN" Only for Purpose of inviting Objection from the general public

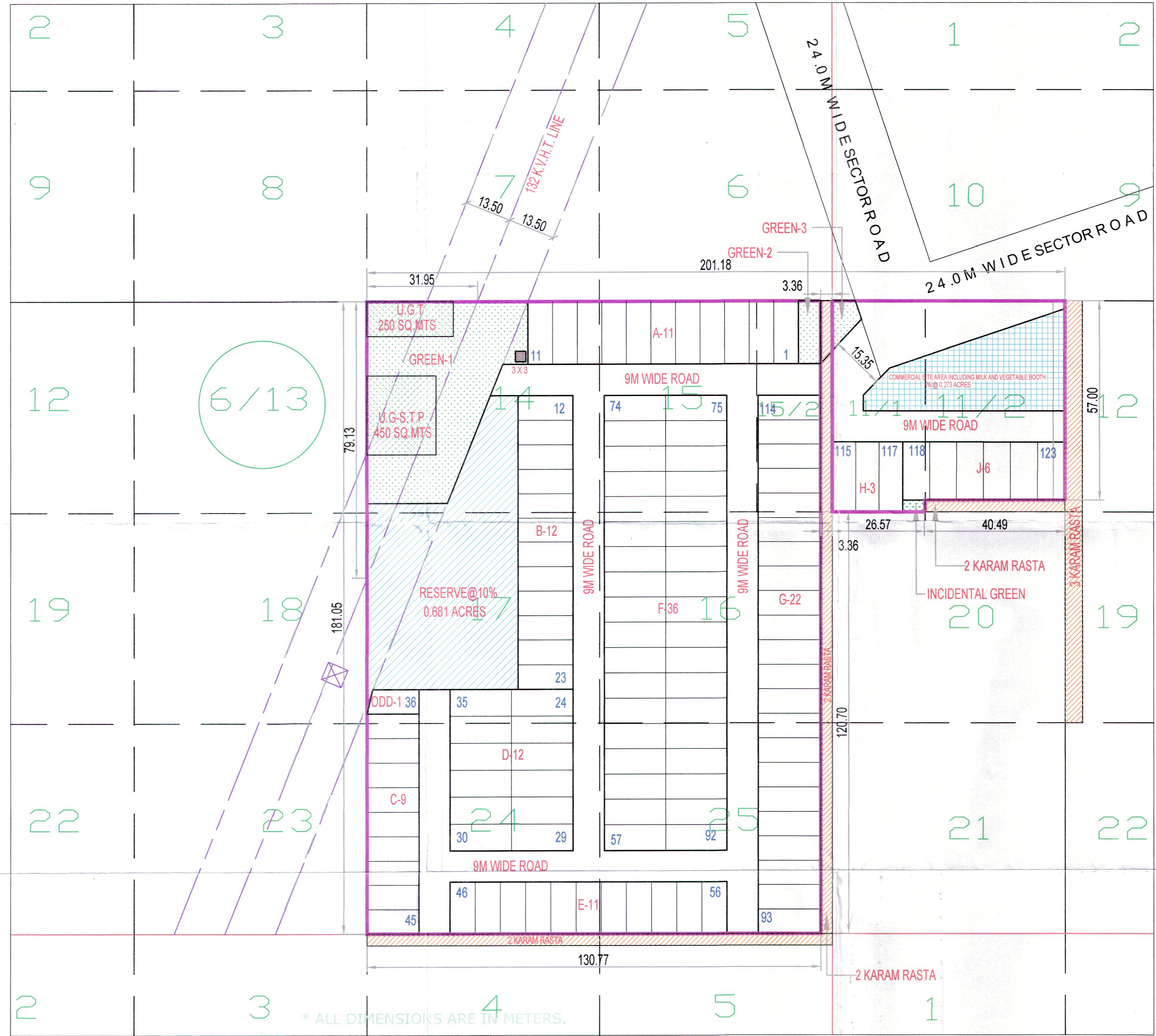

* ALL DIMENSIONS ARE IN METERS.

AREA STATEMENT			
TOTAL AREA OF THE SCHEME	=	6.810 ACRES	
		PERMISSIBLE(IN ACRE)	PROPOSED(IN ACRE) (IN %)
AREA UNDER PLOTS	=	4.154	3.739 54.90
AREA UNDER COMMERCIAL	=	0.272	0.272 4.00
TOTAL SALEBLE AREA	=	4.426	4.011 58.904
AREA UNDER PLOTS			
TYPE	SIZE	AREA	TOTAL PLOTS
A	7.08 x	18.00	127.44
B	7.00 x	15.75	110.25
C	7.01 x	15.00	105.15
D	7.70 x	17.69	136.21
E	7.25 x	14.86	107.74
F	7.22 x	17.69	127.72
G	7.00 x	18.00	126.00
H	6.77 x	19.95	135.06
J	7.78 x	16.60	129.15
ODD-1	AS/PROFILE	AS/PROFILE	89.71
TOTAL			123
			15130.60 Sq.Mt
			3.739 Acres
DENSITY CALCULATION			
TOTAL DENSITY	=	123 x	18.00 @ Person's per Plot
	=	2214	6.8100 Acres
	=	325.110 PPA	Against 240 - 400 PPA permissible
AREA UNDER GREEN			
REQUIRED GREEN	=	0.511 Acres	7.50% of Total area of the Scheme
GREEN AREA PROPOSED			
GREEN - 1	=	0.512 Acres	
GREEN - 2	=	0.028 Acres	
GREEN - 3	=	0.019 Acres	
TOTAL GREEN PROPOSED	=	0.559 Acres	8.21 %
AREA FOR PROVISION OF COMMUNITY FACILITIES			
REQUIRED AREA	=	0.6810 Acres	10.00%

LEGEND	
1. SCHEME BOUNDARY SHOWN THUS	
2. UGTP AREA (450 SQMTS)	
3. UGT AREA (200 SQMTS)	
4. ET AREA (3MX3M)	
5. GREEN AREA SHOWN THUS	
6. COMMERCIAL AREA SHOWN THUS	
7. COMMUNITY FACILITY SHOWN THUS	

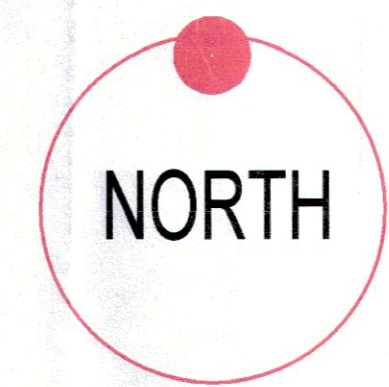

DATE: 02.03.2023

For TDI REALCON PRIVATE LIMITED

 Director/Authorised Signatory

SIGNATURE OF AUTH. SIGN

NORTH:

 SIGNATURE OF ARCHITECT

LAYOUT PLAN FOR SETTING UP OF AN AFFORDABLE PLOTTED COLONY (UNDER DEEN DAYAL JAN AWAS YOJNA -2016) ON THE LAND AREA MEASURING 6.810 ACRES (UNDER MIGRATION FROM LICENSE 1281-1282 OF 2006 GRANTED FOR SETTING UP OF A GROUP HOUSING COLONY FOR AN AREA MEASURING 6.180 ACRES) FALLING IN REVENUE ESTATE OF VILLAGE GARH SHAHJAHANPUR , SECTOR - 17, SONIPAT - TDI REALCON PVT. LTD.